

Trackit M Cleaning Guide





Introduction to Trackit Cleaning Kit

What's included:

- A** 1x Clear Plastic Carrying Case
- B** 10x Fine Tip Cotton Swabs
- C** 1x Black Electronics Brush
- D** 1x 4oz bottle of 70% Isopropyl Alcohol
- E** 1x Microfiber Cloth
- F** 4x Single Packs of Lens Cleaners



[Introduction to Trackit Cleaning Kit](#)
[Cleaning the Trackit M Patient Cable](#)
[Cleaning the Trackit M Patient Cable](#)
[Cleaning the Trackit M Amplifier](#)
[Cleaning the Trackit M Laptop](#)
[For additional assistance](#)



Cleaning the Trackit M Patient Cable

1. Unplug the patient cable from the Trackit M main unit and locate the magnetic connector.
2.
 - a. Remove one of the Fine Tip Cotton Swabs and the 4oz bottle of 70% IPA from the Trackit M Cleaning Kit.
 - b. Carefully remove the top of the bottle of IPA and dip the tip of the cotton swab into the bottle. Dampen the cotton swab and wipe any excess liquid on the side of the bottle. **The cotton swab should not be dripping wet.**
3. Take the dampened cotton swab and make gentle circular motion on each of the magnetic connector gold targets. Use the tip of the cotton swab to remove any fine dirt that has settled at the base of the curve.



IMPORTANT: Let the pins dry before connecting the cable to the main Trackit M unit.



Cleaning the Trackit M Patient Cable

4. A similar method can be used to clean the pins located inside of the Headbox end of the patient cable.
5. Inspect the pins to ensure there is no large debris blocking the channel ports.
6. Dampen a cotton swab using the same method as before and make gentle circular motions around the top of the pin. Do this for all channel pins. DO NOT FORCE THE COTTON SWAB DEEPER THAN THE TIP WILL ALLOW! Ensure that all liquid has dried before connecting any electrodes into the channel ports.

To clean the surface of the headbox cable follow your facilities cleaning guidelines.



Cleaning the Trackit M Amplifier

1. Remove any cables connected to the Trackit M unit and unplug power to the system.
2. Use the brush included in the Trackit M cleaning kit to sweep any large debris away from the pins.
3. Using a dampened cotton swab, make a gentle rotating motion around the top of each gold spring pin. Use the tip of the cotton swab to wipe the very top of the pin. Repeat this for all amplifier pins. Allow all pins to dry before reconnecting any cables.
4. Strong magnets allow the cables to connect to the Trackit M amplifier, so ensure that no debris has settled around these areas. The magnetic areas are located in the brighter teal parts on the amplifier.





Cleaning the Trackit M Laptop

1. Using the provided black electronics brush included in the Trackit M Cleaning Kit, sweep out any dust that has settled into the keyboard.

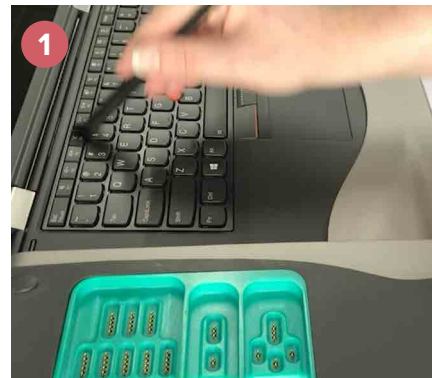

2. Use the provided microfiber cloth wipe the Trackit M touch screen to remove any smudges or stains. Lens wipes can be used to remove tough smudges.

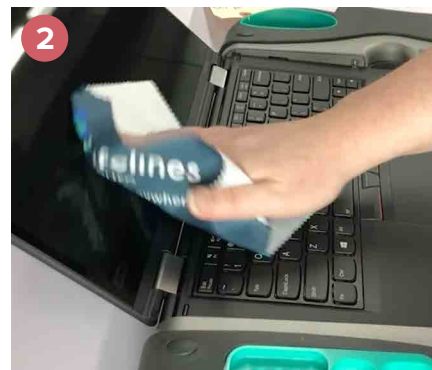

[Introduction to Trackit Cleaning Kit](#)
[Cleaning the Trackit M Patient Cable](#)
[Cleaning the Trackit M Patient Cable](#)
[Cleaning the Trackit M Amplifier](#)
[Cleaning the Trackit M Laptop](#)
[For additional assistance](#)

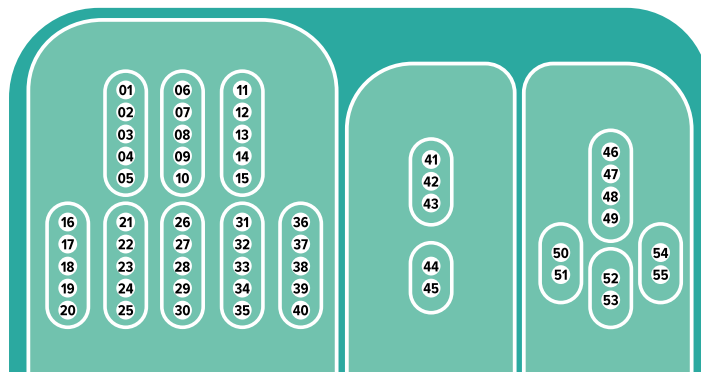

Pin	Signal	Pin	Signal	Pin	Signal	Pin	Signal	Pin	Signal
01	SHLD	12	T5	23	DGND	34	FP1	45	LEDA
02	X6	13	X1	24	M1	35	F3	46	SHLD_PER
03	X4	14	X3	25	M2	36	C3	47	LF
04	X2	15	X5	26	REF	37	P3	48	LB
05	NEG	16	FP2	27	F4	38	O1	49	PER_GND
06	X7	17	T6	28	C4	39	F7	50	ET_TX
07	D1	18	T4	29	P4	40	A1	51	ET_RX
08	D3	19	A2	30	O2	41	EM_GND	52	ET_CTS
09	D2	20	F8	31	Pz	42	DET	53	ET_RTS
10	X8	21	M3	32	Fz	43	SW	54	RUN
11	T3	22	NEUT	33	Cz	44	LEDC	55	STIM

[Introduction to Trackit Cleaning Kit](#)
[Cleaning the Trackit M Patient Cable](#)
[Cleaning the Trackit M Patient Cable](#)
[Cleaning the Trackit M Amplifier](#)
[Cleaning the Trackit M Laptop](#)
[For additional assistance](#)

For additional assistance

Tel: 866-889-6505

Email: support@lifelinesneuro.com

